

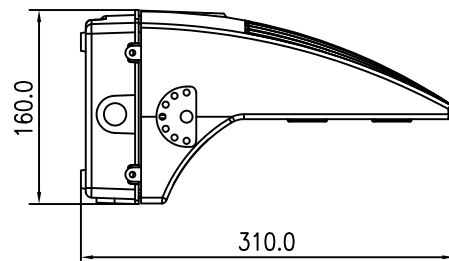

Wp200 Series LED Wallpack Light

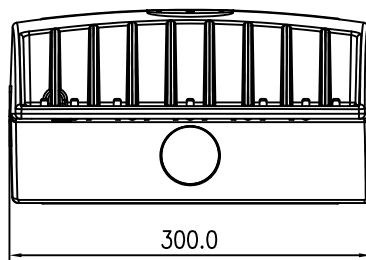

Introduction

The WP200 Series distills the benefits of the latest in LED technology into a high performance, high efficacy, long-life luminaire. It features a sleek, modern design and is carefully engineered to provide long-lasting, energy-efficient lighting with a variety of optical and control options for customized performance.

The energy savings, long life and easy-to-install design of the Wallpack make it the smart choice for building-mounted doorway and pathway illumination for nearly any facility.

Specifications

Luminaire
Width :300mm (11-4/5")
Depth :310mm(12-1/5")
Height:160mm(6-1/3")
Weight:6kg(12.2lb)

ORDERING INFORMATION

ORDERING INFORMATION:						
EXAMPLE:WP201L-40W-30K-T2-00-BR						
MODEL	OPTIONS	POWER	COLOR	DISTRI-BUTION	CONTROL OPTIONS	FINISH
WP201	L:100-277VAC H:200-480VAC C:100-277VAC with photoelectric switch	40W	30K:3000K	T2 T3 T4 T5	00: NO DIMMING 10: 0-10V DIMMING SR: WITH SENSOR	BR-Bronze (RAL8028) WH(White) (RAL9010) BL-Black (RAL9017)
WP202		60W	35K:3500K			
WP203		80W	40K:4000K			
WP204		100W	45K:4500K			
WP205		120W	50K:5000K 57K:5700K			

REGULATORY & VOLUNTARY QUALIFICATIONS

- cULus Listed.
- Suitable for wet locations.
- minimum 2KV surge rating, (Options:10kV surge suppression protection tested in accordance with IEEE/ANSI C62.41.2.)
- Meets FCC Part 15 standards for conducted and radiated emissions.
- RoHS compliant. Consult factory for additional details.
- DesignLights Consortium ®(DLC) qualified product. Not all versions of this product may be DLC qualified. Please check the DLC Qualified Products List at www.designlights.org to confirm which versions are qualified.

WP200 Series Performance Data

Lumen Output

Lumen values are from photometric tests performed in accordance with IESNA LM-79-08. Data is considered to be representative of the configurations shown, within the tolerances allowed by Lighting Facts. Actual performance may differ as a result of enduser environment and application. Actual wattage may differ by +/- 10% when operating between 120-480V +/- 10%. Contact factory for performance data on any configurations not shown here.

MODEL	LEDS	LED CURRENT	RATED WATTS	DIST TYPE	30K(3000K,70CRT)					40K(4000K,70CRT)					57K(5700K,70CRT)				
					LUMENS	B	U	G	LPW	LUMENS	B	U	G	LPW	LUMENS	B	U	G	LPW
WP201	16	0.75A	40W	T2	4941	1	0	1	123.5	5015	1	0	1	125.4	5485	2	0	2	137.1
				T3	4899	1	0	1	122.5	4972	1	0	1	124.3	5438	1	0	1	135.9
				T4	4835	1	0	1	120.9	4908	1	0	1	122.7	5367	1	0	1	134.2
WP202	16	1.15A	65W	T2	6760	2	0	2	104.0	7064	2	0	2	108.7	7639	2	0	2	117.5
				T3	6831	2	0	2	105.1	7138	2	0	2	109.8	7719	2	0	2	118.8
				T4	6807	2	0	2	104.7	7113	2	0	2	109.4	7692	2	0	2	118.3
WP203	32	0.75A	80W	T2	9586	2	0	2	119.8	9730	2	0	2	121.6	10640	2	0	2	133.0
				T3	9628	2	0	2	120.4	9772	2	0	2	122.2	10687	2	0	2	133.6
				T4	9662	2	0	2	120.8	9807	2	0	2	122.6	10725	2	0	2	134.1
WP204	32	0.9A	100W	T2	10764	2	0	2	107.6	11087	2	0	2	110.9	12056	2	0	2	120.6
				T3	10698	2	0	2	107.0	11019	2	0	2	110.2	11982	2	0	2	119.8
				T4	10822	2	0	2	108.2	11147	2	0	2	111.5	12121	2	0	2	121.2
WP205	32	1.15A	120W	T2	12000	2	0	2	100.0	12480	2	0	2	104.0	13560	3	0	3	113.0
				T3	12144	2	0	2	101.2	12630	2	0	2	105.2	13723	3	0	3	114.4
				T4	12194	2	0	2	101.6	12682	2	0	2	105.7	13779	3	0	3	114.8

Electrical Data

MODEL	LEDS	LED CURRENT	SYSTEM WATTS	Current					
				120	208	240	277	347	480
WP201	16	0.75A	40W	0.35	0.20	0.18	0.16	-	-
WP202		1.15A	65W	0.55	0.32	0.29	0.26	0.19	0.15
WP203	32	0.75A	80W	0.75	0.40	0.35	0.32	-	-
WP204		0.9A	100W	0.85	0.50	0.44	0.40	0.29	0.21
WP205		1.15A	120W	1.00	0.60	0.55	0.45	-	-

Lumen Ambient Temperature (LAT) Multipliers

Ambient	Lumen Multiplier	
0°C	32°F	1.02
10°C	50°F	1.01
20°C	68°F	1.00
25°C	77°F	1.00
30°C	86°F	1.00
40°C	104°F	0.99

Luminaire Lumen Maintenance Factors (LMF)

Data references the extrapolated performance projections for the platforms noted in a 25°C ambient, based on 10,000 hours of LED testing (tested per IESNA LM-80-08 and projected per IESNA TM-21-11).

To calculate LMF, use the lumen maintenance factor that corresponds to the desired number of operating hours below. For other lumen maintenance values, contact factory.

Operating Hours	0	25000	50000	75000	100000
Lumen Maintenance Factor	WP201 16 LEDES 0.75A				
	1	0.92	0.85	0.8	0.75
Lumen Maintenance Factor	WP205 32 LEDES 1.15A				
	1	0.91	0.85	0.79	0.73

ELECTRICAL SYSTEM

- Input Voltage: 100-277V or 347-480V, 50/60Hz
- Designed with 0-10V dimming capabilities. Controls by others.
- Power Factor : > 0.9 at full load
- Total Harmonic Distortion: < 20% at full load
- Integral 10kV surge suppression protection standar(options)
- Luminaire is qualified to operate at ambient temperatures of -40°C to +50°C.

FINISH

Exterior parts are protected by Super Durable thermoset powder coat finish that provides superior resistance to corrosion and weathering. A tightly controlled multi-stage process ensures a minimum 3 mils thickness for a finish that can withstand extreme climate changes without cracking or peeling. Available in textured and non-textured finishes.

INSTALLATION

Included universal mounting bracket attaches securely to any 4" round or square outlet box for quick and easy installation. Luminaire has a slotted gasket wireway and attaches to the mounting bracket via corrosion-resistant screws.

WARRANTY

- Five year limited warranty.